

The Great Grid Upgrade

Sea Link

Sea Link

Volume 2: Plans and Drawings

Document 2.3: Land Plans Summary of Changes Part 1 of 2

Planning Inspectorate Reference: EN020026

**Version: C Version 2, change request
November 2025**

**Infrastructure Planning (Applications: Prescribed Forms and Procedure)
Regulations 2009 Regulation 5(2)(i)**

nationalgrid

Page intentionally left blank

2.3.1 Land Plans - Suffolk



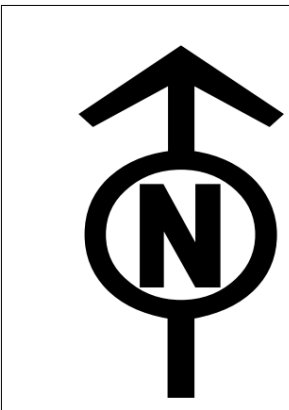

THE NATIONAL GRID (SEA LINK) ORDER
PINS APPLICATION NUMBER: EN020026
LAND PLANS - SUFFOLK
REGULATION 5(2)(i)(i)-(iii)
SHEET 1 OF 7
IN THE DISTRICT OF EAST SUFFOLK DISTRICT COUNCIL

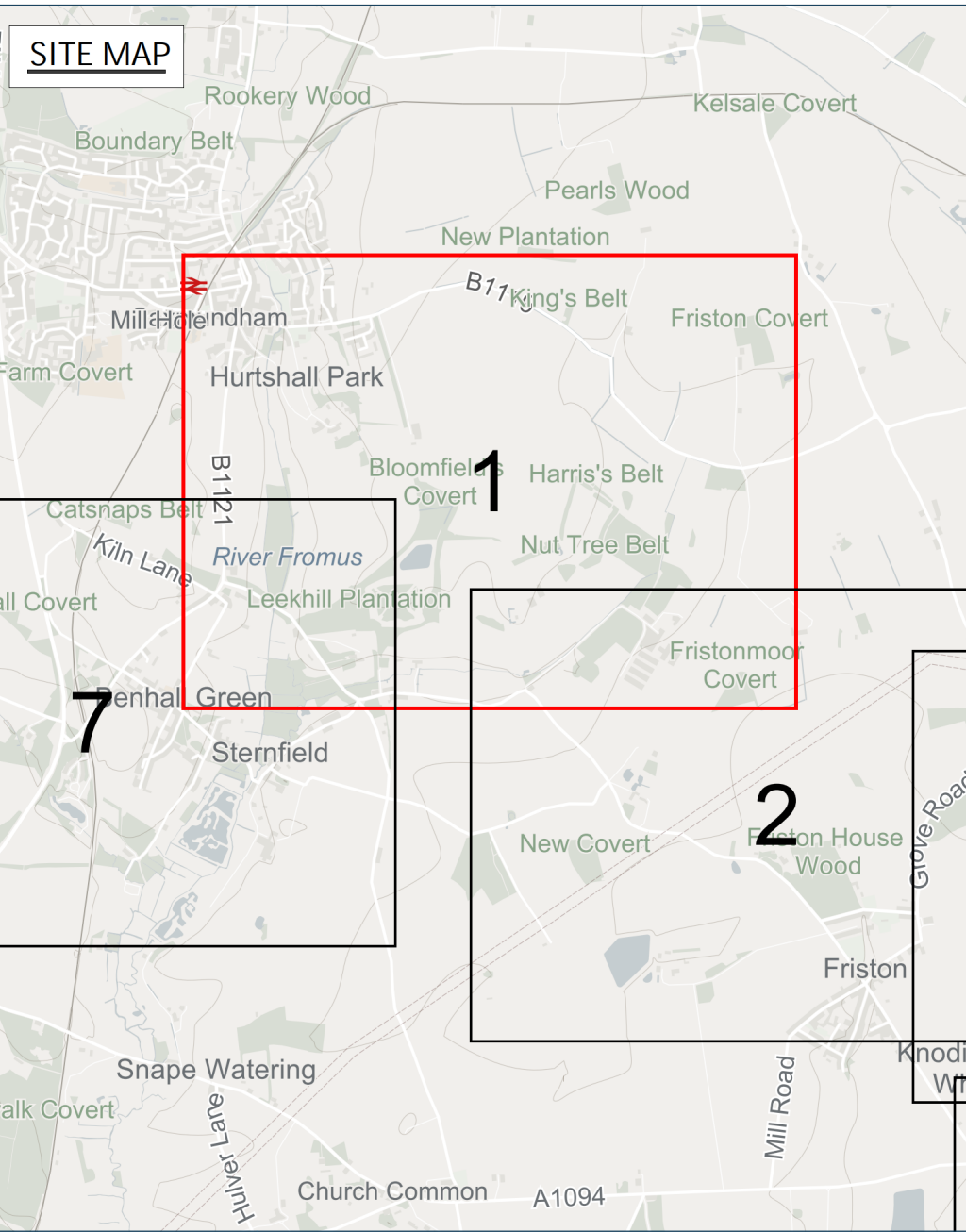
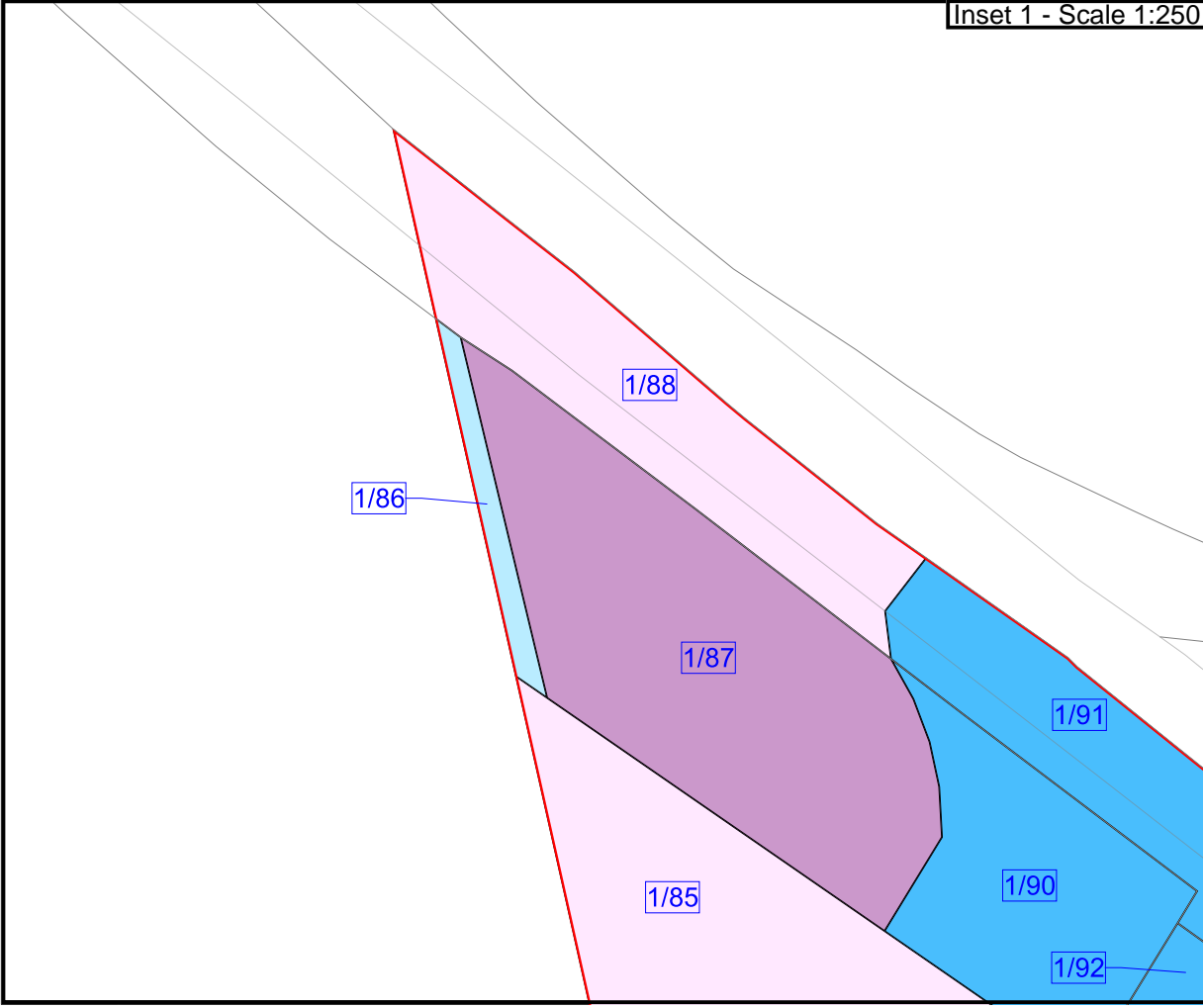

Application Document 2.3.1

- Legend**
- Order Limits
 - Class 1. Compulsory Acquisition of land
 - Class 2. Compulsory Acquisition of Rights – Overhead Line
 - Class 3. Compulsory Acquisition of Rights – Underground Cable System
 - Class 4. Compulsory Acquisition of Rights – Construction Compound
 - Class 5. Compulsory Acquisition of Rights – Access
 - Class 6. Compulsory Acquisition of Rights – Drainage
 - Class 7. Compulsory Acquisition of Rights – Mitigation
 - Class 8. Temporary use for Construction, Mitigation, Maintenance, and Dismantling of Redundant Infrastructure
 - Class 9. Temporary Use for Access
 - Class 10. Land that is not subject to powers of acquisition nor temporary use

Notes

1. This plan is scaled at paper size A0, therefore any prints taken at smaller sizes will affect accuracy of the measurement units and should not be scaled against.
2. For further information in regard to what the plans are showing please see 'Guide to the Plans' (Document Ref 2.1)
3. This plan only shows plots from areas added to the order limits in October 2025

Coordinate System: British National Grid
Sheet X Centroid Coordinate: 639687
Sheet Y Centroid Coordinate: 262330

BACKGROUND MAPPING INFORMATION HAS BEEN REPRODUCED FROM THE ORDNANCE SURVEY BY PERMISSION OF ORDNANCE SURVEY OR THE CONTROLLER OF HIS MAJESTY'S STATIONERY OFFICE. ORDNANCE SURVEY ORDNANCE SURVEY © 1980/2006

C ver	Date	Change Request Version	HDA	ZHU	LJD
C ver 2	21/11/2025	Change Request Version	HDA	ZHU	LJD
C	19/11/2025	For Deadline 1A	HDA	ZHU	LJD
B	29/10/2025	Version 2. Change Request	HDA	ZHU	LJD
A	06/05/2025	For Submission	FMA	OFO	LJD
Issue	Date	Remarks	Drawn	Checked	Approved

Title					
THE NATIONAL GRID (SEA LINK) ORDER PINS APPLICATION NUMBER: EN020026 LAND PLANS - SUFFOLK REGULATION 5(2)(i)(i)-(iii) SHEET 1 OF 7 IN THE DISTRICT OF EAST SUFFOLK DISTRICT COUNCIL					
Change 5 - Increase in area for maintenance of a new hedge to south of B1119, Suffolk					
nationalgrid					
Application Number					
EN020026					
National Grid Drawing Reference					
CHANGEAPP/SLR/PS/0114					
Scale	Sheet Size	Sheet	Issue		
1:2,500	A0	SHEET 1 OF 7	C ver.2		

FOR CONTINUATION SEE SHEET 2

FOR CONTINUATION SEE SHEET 2

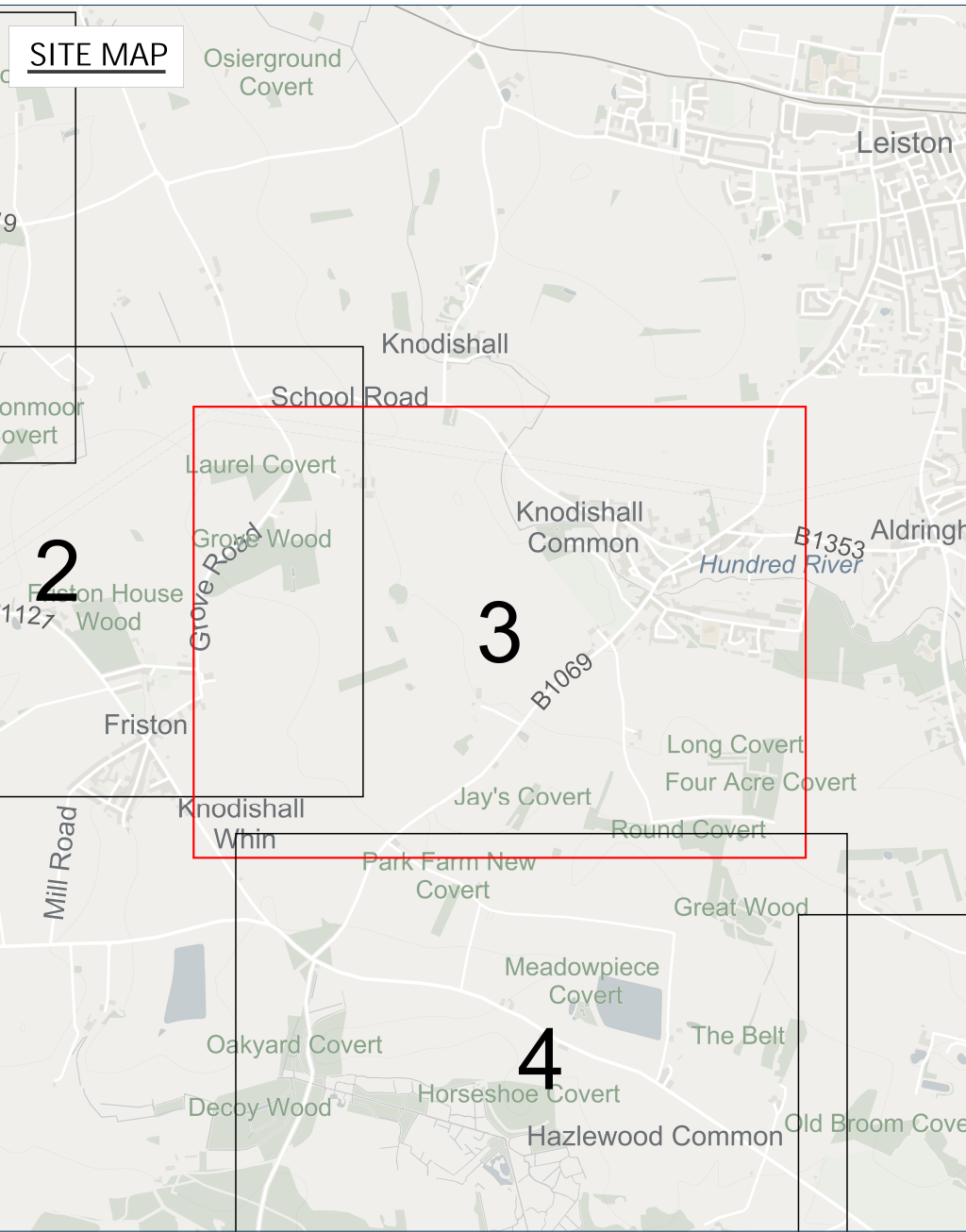
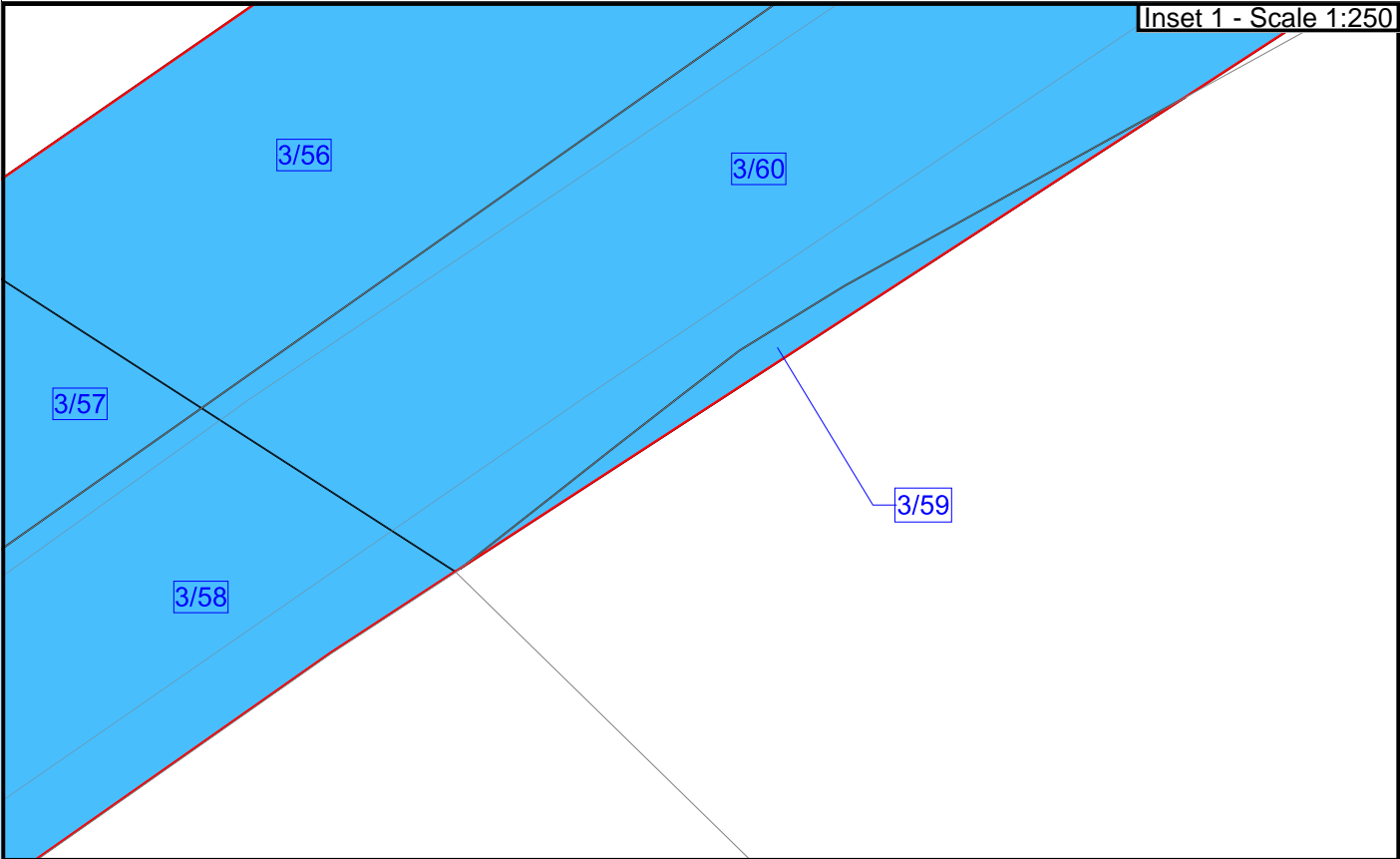

Legend

- ## Notes

Coordinate System: British National Grid
Sheet X Centroid Coordinate: 642755 Sheet Y Centroid Coordinate: 260670



A horizontal scale bar with alternating black and white segments. Numerical labels are placed above the bar at intervals of 25, starting from 25 and ending at 200. The word 'Metres' is centered below the bar.

BACKGROUND MAPPING INFORMATION HAS BEEN REPRODUCED FROM THE ORDNANCE SURVEY BY PERMISSION OF ORDNANCE SURVEY OF THE CONTROLLER OF HIS MAJESTY'S STATIONERY OFFICE. CROWN COPYRIGHT ORDNANCE SURVEY © - 100042766.

Title

THE NATIONAL GRID (SEA LINK) ORDER
PINS APPLICATION NUMBER: EN020026
LAND PLANS - SUFFOLK
REGULATION 5(2)(i)-(iii)
SHEET 3 OF 7
IN THE DISTRICT OF
EAST SUFFOLK DISTRICT COUNCIL

Change 3 - The Henge, Suffolk

nationalgrid

Application Number

NO20026

National Grid Drawing Reference

CHANGEAPP/S/LRP/S/0116

<u>Scale</u>	<u>Sheet Size</u>	<u>Sheet</u>	<u>Issue</u>
1:2,500	A0	SHEET 3 OF 7	C ver.2

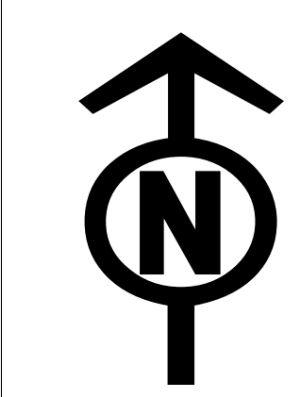

THE NATIONAL GRID (SEA LINK) ORDER
PINS APPLICATION NUMBER: EN020026
LAND PLANS - SUFFOLK
REGULATION 5(2)(i)-(iii)
SHEET 7 OF 7
IN THE DISTRICT OF EAST SUFFOLK DISTRICT COUNCIL

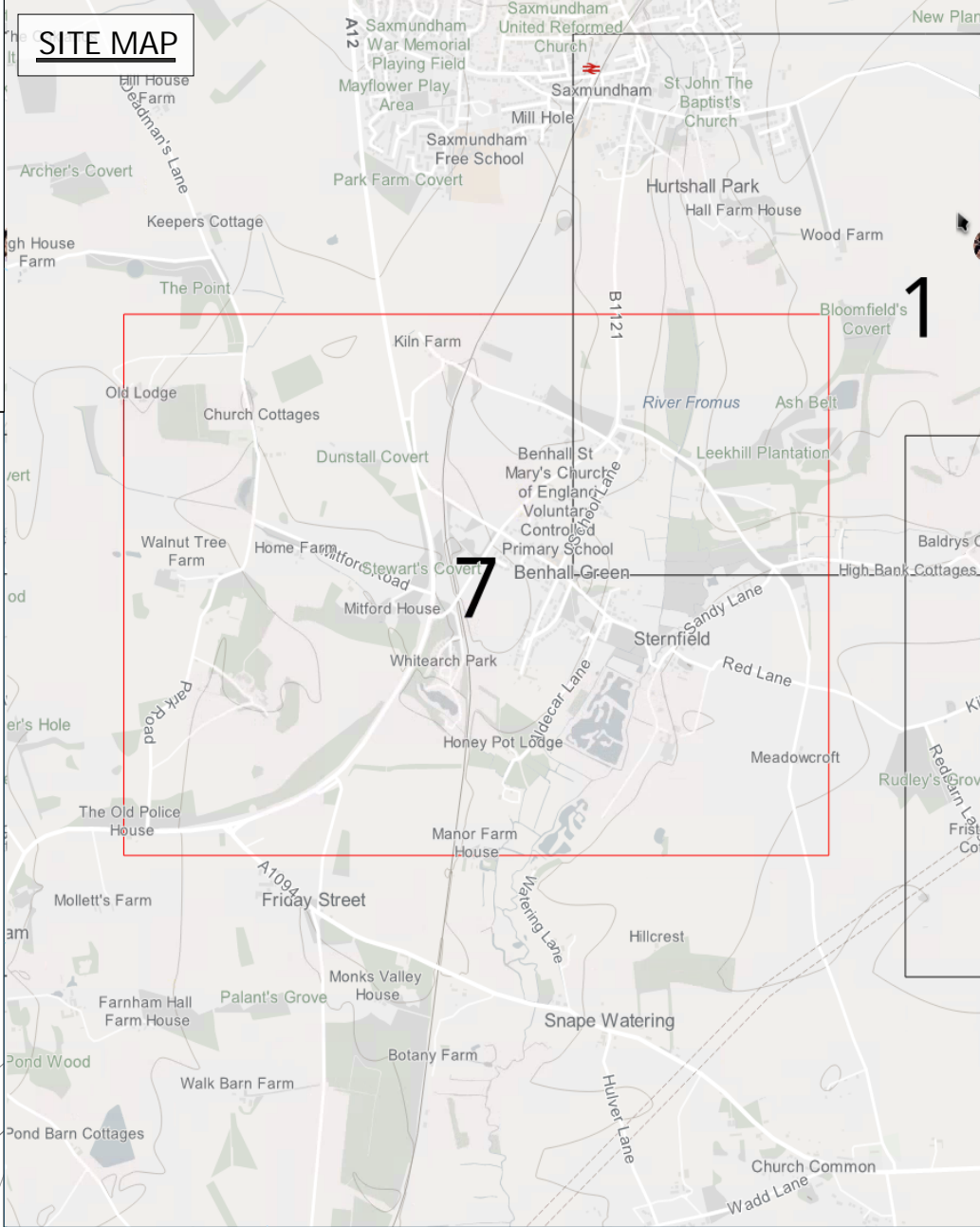
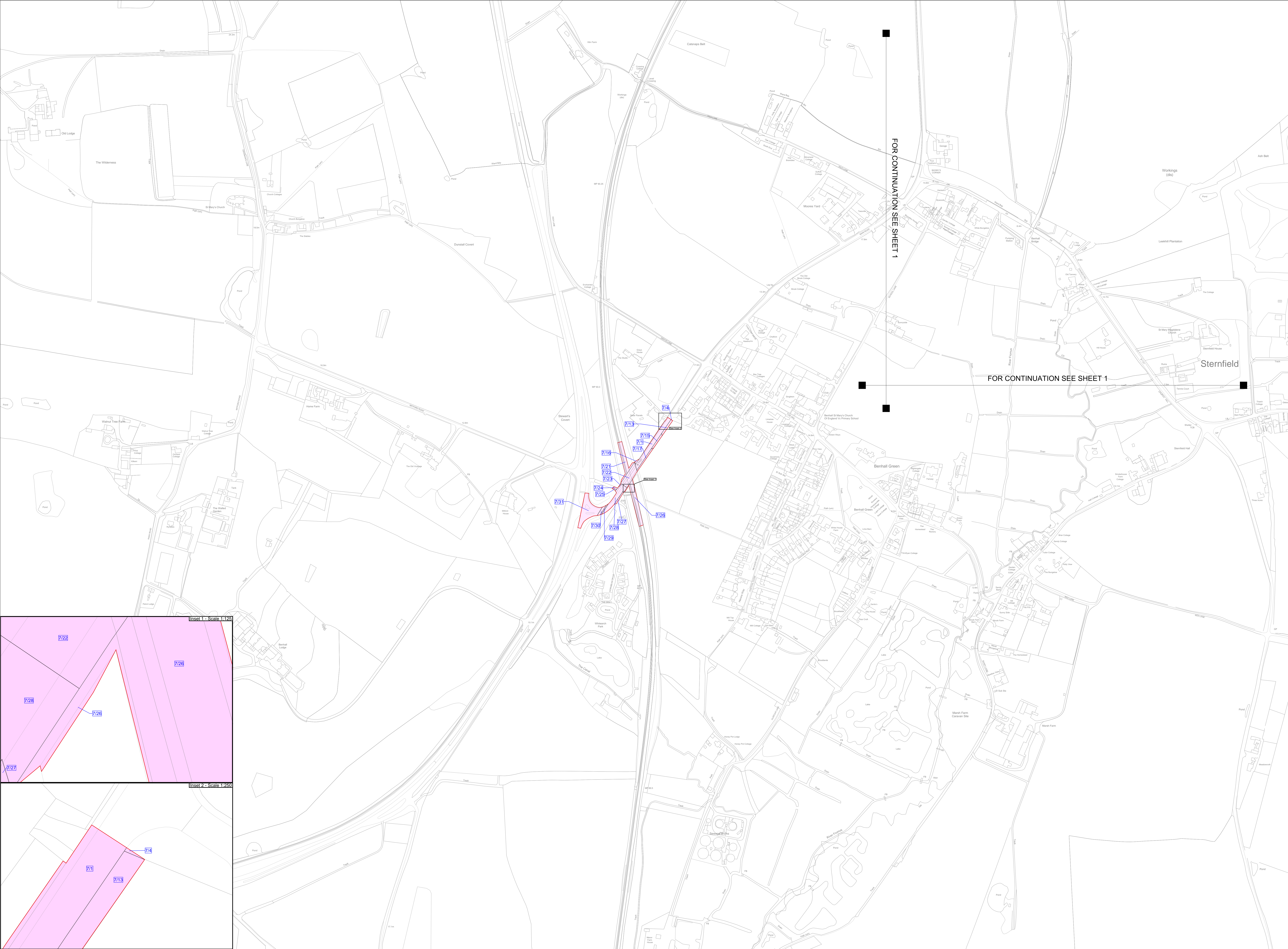

Application Document 2.3.1

- Legend**
- Order Limits
 - Class 1. Compulsory Acquisition of land
 - Class 2. Compulsory Acquisition of Rights – Overhead Line
 - Class 3. Compulsory Acquisition of Rights – Underground Cable System
 - Class 4. Compulsory Acquisition of Rights – Construction Compound
 - Class 5. Compulsory Acquisition of Rights – Access
 - Class 6. Compulsory Acquisition of Rights – Drainage
 - Class 7. Compulsory Acquisition of Rights – Mitigation
 - Class 8. Temporary use for Construction, Mitigation, Maintenance, and Dismantling of Redundant Infrastructure
 - Class 9. Temporary Use for Access
 - Class 10. Land that is not subject to powers of acquisition nor temporary use

- Notes**
1. This plan is scaled at paper size A0, therefore any prints taken at smaller sizes will affect accuracy of the measurement units and should not be scaled against.
 2. For further information in regard to what the plans are showing, please see 'Guide to the Plans' (Document Ref 2.1)
 3. This plan only shows plots from areas added to the order limits in October 2025

Coordinate System: British National Grid
Sheet X Centroid Coordinate: 638017 Sheet Y Centroid Coordinate: 261317

25 0 25 50 75 100 125 150 175 200
Metres

BACKGROUND MAPPING INFORMATION HAS BEEN REPRODUCED FROM THE ORDNANCE SURVEY OF GREAT BRITAIN BY ORDNANCE SURVEY OF THE CONTROLLER OF HIS MAJESTY'S STATIONERY OFFICE. ORDNANCE SURVEY OF GREAT BRITAIN. 1:50,000.

C ver 2	21/11/2025	Change Request Version	HDA	ZHU	UJO
C	19/11/2025	For Deadline 1A	HDA	ZHU	UJO
B	04/11/2025	Version 2. Change Request	HDA	ZHU	UJO
A	03/10/2025	For Submission	ZHU	KGA	UJO
Issue	Date	Remarks	Drawn	Checked	Approved

Title

THE NATIONAL GRID (SEA LINK) ORDER
PINS APPLICATION NUMBER: EN020026
LAND PLANS - SUFFOLK
REGULATION 5(2)(i)-(iii)
SHEET 7 OF 7
IN THE DISTRICT OF
EAST SUFFOLK DISTRICT COUNCIL

Change 4 - Benhall Railway Bridge

nationalgrid			
Application Number: EN020026			
National Grid Drawing Reference: CHANGEAPP/S/LRP/S/0117			
Scale: 1:2,500	Sheet Size: A0	Sheet: SHEET 7 OF 7	Issue: C ver 2